



HV & UHV Vacuum Products Catalogue

- ▶ **COMPONENTS**
- ▶ **CONSUMABLES**
- ▶ VALVES
- ▶ PUMPS
- ▶ GAUGES
- ▶ MANIPULATION

- ▶ MASS FLOW
- ▶ FEEDTHROUGHS
- ▶ CHAMBERS
- ▶ ASSEMBLIES
- ▶ MATERIALS
- ▶ SYSTEMS

KF Flanges and Components

- Clamps



KF Clamps

Page

B39 Clamps. Al/SS Swing. Quick Release. Bulkhead
B40 Clamps. Bolt. Metal Seal. Hingless. Chain

CONTENTS

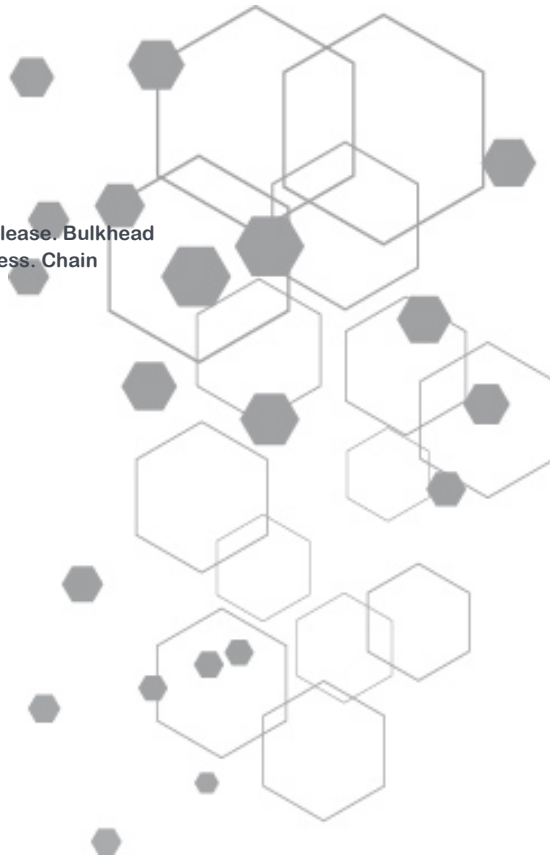

KF Clamps

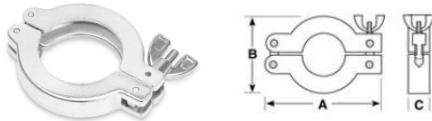

▪ **Standard, Cast Aluminium**

NW	A dimension	B dimension	C dimension	Part Code
KF16/10	63	43	16	KF16CAL
KF25	72	54	16	KF25CAL
KF40/32	90	70	16	KF40CAL
KF50	113	92	22	KF50CAL

- 2Nm wingnut torque
- use with elastomer seals
- temp: -196 to 200°C



▪ **Heavy Duty, Machined SS**

KF16/10	41	16	-	KF16CSS
KF25	63	16	-	KF25CSS
KF40/32	75	16	-	KF40CSS
KF50	101	16	-	KF50CSS

- 9.5Nm thumb screw torque
- machined from solid bar
- corrosive environments
- temp: -195 to 300°C

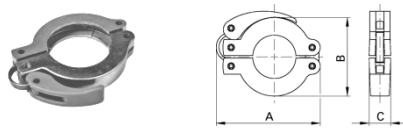

▪ **Quick Release, Aluminium/Plastic**

KF16/10	68	45	16	KF16CALQ
KF25	80	55	16	KF25CALQ
KF40/32	98	70	18	KF40CALQ
KF50	108	96	21	KF50CALQ

- one hand operation
- use with elastomer seals
- temp: -10 to 80°C

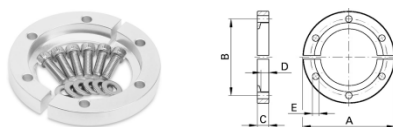

▪ **Bulkhead, Aluminium (with bolt kit)**

KF16/10	50.8	38.1	9.2	KF16BHCAL
KF25	60.3	48	9.9	KF25BHCAL
KF40/32	74.6	62	9.3	KF40BHCAL
KF50	95.2	82.6	10.3	KF50BHCAL

- for use with elastomer seals
- steel bolt and washer kit
- for baseplate mounting
- temp: -195 to 200°C

all dimensions are measured in millimetres (mm) unless otherwise stated

KF Clamps

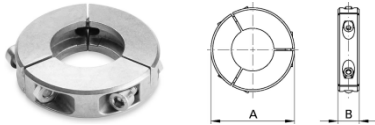

▪ **Bolt Clamp 3-part, Cast Aluminium**

NW	A dimension	B dimension	C dimension	Part Code
KF16/10	48	18	-	KF16BCAL
KF25	70	19	-	KF25BCAL
KF40/32	85	23	-	KF40BCAL
KF50	112	28	-	KF50BCAL

- steel bolt kit
- use with metal seals
- temp: -196 to 200°C

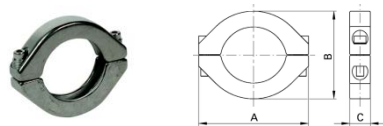

▪ **Metal Seal Clamp, SS 304**

KF16/10	55	47	18	KF16CMS
KF25	66.5	57	18	KF25CMS
KF40/32	82.5	72	18	KF40CMS
KF50	122	96	21	KF50CMS

- for metal/elastomer seals
- corrosive environments
- temp: -195 to 300°C

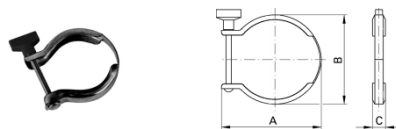

▪ **Hingless Clamp, Sprung Steel/Plastic**

KF16/10	47	38	16	KF16CHS
KF25	54	49	16	KF25CHS
KF40/32	70	62	16	KF40CHS
KF50	90	84	16	KF50CHS

- slim compact design
- 2Nm wingnut torque
- use with elastomer seals
- temp: -10 to 125°C

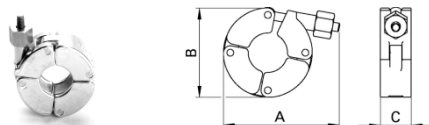

▪ **Chain Clamp, Aluminium/SS**

KF16/10	71	52.5	18	KF16CCAL
KF25	82	65	18	KF25CCAL
KF40/32	98	79	18	KF40CCAL
KF50	117	97.6	20	KF50CCAL

- for metal/elastomer seals
- steel thumb turn bolt
- temp: -195 to 200°C

all dimensions are measured in millimetres (mm) unless otherwise stated



Contact us...



k-tech supplies ltd
wild thyme
udimore road
broadland row
broad oak
rye
east sussex
tn31 6bx
united kingdom

web : www.ktechsupplies.co.uk
email : enquiries@ktechsupplies.co.uk
tel : +44 (0)1424 400 235
fax : +44 (0)7006 044 223