



# HV & UHV Vacuum Products Catalogue

- ▶ **COMPONENTS**
- ▶ **CONSUMABLES**
- ▶ VALVES
- ▶ PUMPS
- ▶ GAUGES
- ▶ MANIPULATION

- ▶ MASS FLOW
- ▶ FEEDTHROUGHS
- ▶ CHAMBERS
- ▶ ASSEMBLIES
- ▶ MATERIALS
- ▶ SYSTEMS

# ISO Flanges and Components

- Elbows



## ISO Elbows

Page

C10	ISO-K.Swept Elbow. 90° Radius. 304L
C11	ISO-K. Swept Elbow. 45° Radius. 304L
C12	ISO-K. Mitred Elbow. 90°. 304L

### CONTENTS

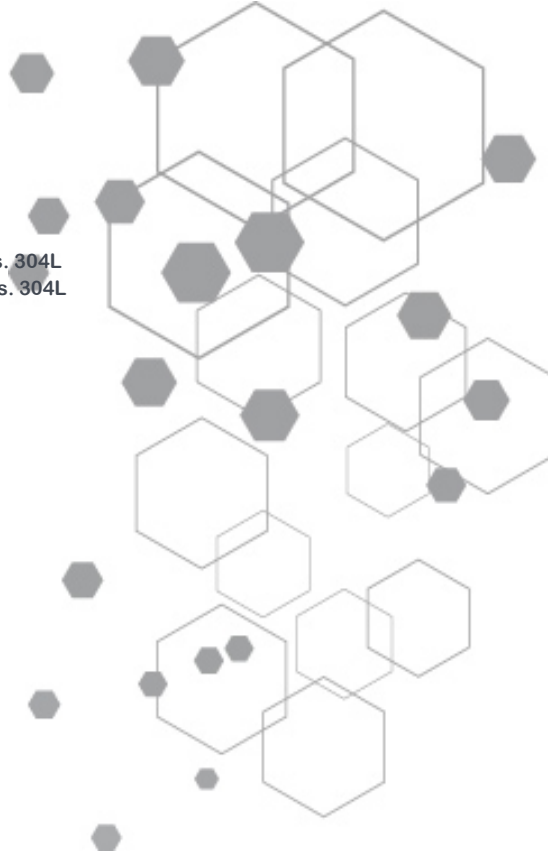

ISO-K Swept Elbows | 90° Radius

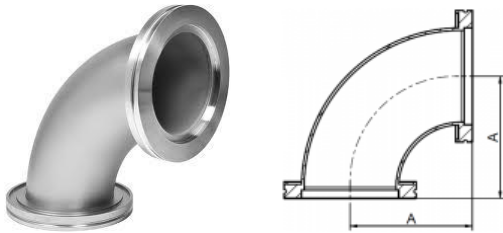

- Standard material SS 304L ...also available in 316L and Al
- Temperature range: -195 to 300°C ...200°C; Al. 350°C; 316L
- Other flange size options, including ISO-F, manufactured by request
- Full range of centering rings, O-rings and clamps in-stock

NW	A dimension	Tube OD	Wall	Part Code
ISO63-K	102.0	63.5	1.5	ISO63KSEL
ISO80-K	120.0	76.2	1.5	ISO80KSEL
ISO100-K	159.0	101.6	1.5	ISO100KSEL
ISO160-K	235.0	152.4	1.5	ISO160KSEL
ISO200-K	311.0	203.2	1.5	ISO200KSEL
ISO250-K	387.0	254.0	1.5	ISO250KSEL

all dimensions are measured in millimetres (mm) unless otherwise stated

Centering Rings & O-rings and Clamps

NW	Type	Part Code
ISO63	SS/VITON*	ISO63CRVSS
ISO80	SS/VITON*	ISO80CRVSS
ISO100	SS/VITON*	ISO100CRVSS
ISO160	SS/VITON*	ISO160CRVSS
ISO200	SS/VITON*	ISO200CRVSS
ISO250	SS/VITON*	ISO250CRVSS

\*Fluorocarbon (temp range -15 to 150°C). Other Centering/O-ring materials available

ISO63-100-K	Aluminium	ISO63/100DCCAL
ISO160-250-K	Aluminium	ISO160/250DCCAL

other clamp materials and styles available

ISO-K Swept Elbows | 45° Radius



- Standard material SS 304L ...also available in 316L and Al
- Temperature range: -195 to 300°C ...200°C; Al. 350°C; 316L
- Other flange size options, including ISO-F, manufactured by request
- Full range of centering rings, O-rings and clamps in-stock

NW	A dimension	Tube OD	Wall	Part Code
ISO63-K	82.5	63.5	1.5	ISO63KSEL45
ISO80-K	99.8	76.2	1.5	ISO80KSEL45
ISO100-K	127.5	101.6	1.5	ISO100KSEL45
ISO160-K	246.6	152.4	1.5	ISO160KSEL45

all dimensions are measured in millimetres (mm) unless otherwise stated

Centering Rings & O-rings and Clamps

NW	Type	Part Code
ISO63-K	SS/VITON*	ISO63CRVSS
ISO80-K	SS/VITON*	ISO80CRVSS
ISO100-K	SS/VITON*	ISO100CRVSS
ISO160-K	SS/VITON*	ISO160CRVSS

\*Fluorocarbon (temp range -15 to 150°C). Other Centering/O-ring materials available

ISO63-100-K	Aluminium	ISO63/100DCCAL
ISO160-250-K	Aluminium	ISO160/250DCCAL

other clamp materials and styles available

ISO-K Mitred Elbows | 90°

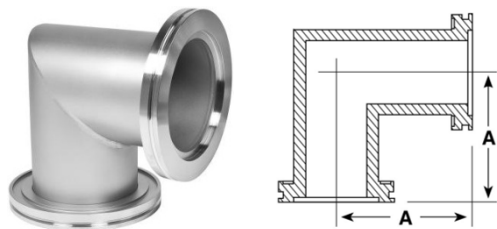

- Standard material SS 304L ...also available in 316L and Al
- Temperature range: -195 to 300°C ...200°C; Al. 350°C; 316L
- Other flange size options, including ISO-F, manufactured by request
- Full range of centering rings, O-rings and clamps in-stock

NW	A dimension	Tube OD	Wall	Part Code
ISO63-K	87.9	63.5	1.5	ISO63KMEL
ISO80-K	98.0	76.2	1.5	ISO80KMEL
ISO100-K	108.0	101.6	1.5	ISO100KMEL
ISO160-K	138.0	152.4	1.5	ISO160KMEL
ISO200-K	168.0	203.2	1.5	ISO200KMEL
ISO250-K	207.8	254.0	1.5	ISO250KMEL

all dimensions are measured in millimetres (mm) unless otherwise stated

Centering Rings & O-rings and Clamps

NW	Type	Part Code
ISO63	SS/VITON*	ISO63CRVSS
ISO80	SS/VITON*	ISO80CRVSS
ISO100	SS/VITON*	ISO100CRVSS
ISO160	SS/VITON*	ISO160CRVSS
ISO200	SS/VITON*	ISO200CRVSS
ISO250	SS/VITON*	ISO250CRVSS

\*Fluorocarbon (temp range -15 to 150°C). Other Centering/O-ring materials available

ISO63-100-K	Aluminium	ISO63/100DCCAL
ISO160-250-K	Aluminium	ISO160/250DCCAL

other clamp materials and styles available



Contact us...



k-tech supplies ltd  
wild thyme  
udimore road  
broadland row  
broad oak  
rye  
east sussex  
tn31 6bx  
united kingdom

web : [www.ktechsupplies.co.uk](http://www.ktechsupplies.co.uk)  
email : [enquiries@ktechsupplies.co.uk](mailto:enquiries@ktechsupplies.co.uk)  
tel : +44 (0)1424 400 235  
fax : +44 (0)7006 044 223