



HV & UHV Vacuum Products Catalogue

- ▶ **COMPONENTS**
- ▶ **CONSUMABLES**
- ▶ VALVES
- ▶ PUMPS
- ▶ GAUGES
- ▶ MANIPULATION

- ▶ MASS FLOW
- ▶ FEEDTHROUGHS
- ▶ CHAMBERS
- ▶ ASSEMBLIES
- ▶ MATERIALS
- ▶ SYSTEMS

CF Flanges and Components

- Reducers

CONTENTS



CF Reducers

Page

A34	Reducer. Straight. Clearance Holes. 304L
A35	Reducer. Conical. Clearance Holes. 304L

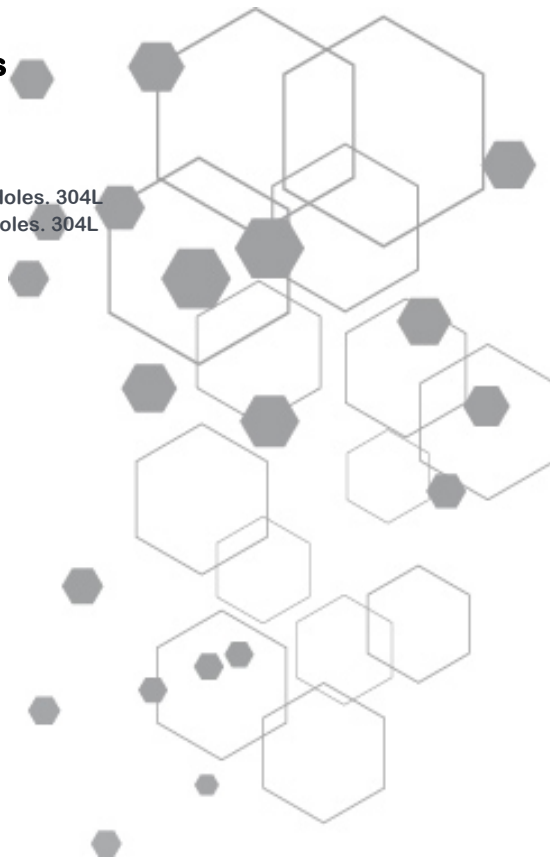

CF Reducers | Straight | Clearance Holes | SS 304L

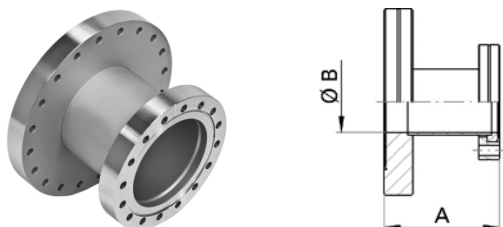

- Standard material: SS 304L
- Also available in SS 316LN and Aluminium
- Larger flange fixed/Smaller flange rotatable. Fixed flanges by request
- Other tube lengths fabricated by request
- Other flange size combinations fabricated by request
- Use hex head bolt sets for clearance hole flanges
- Pressure range 1×10^{-9} mbar
- Temperature range: -195 to 300°C
- Full range of gaskets and bolt sets available in stock

SIZE	Smaller ¹ OD	Larger ² OD	A dim	B dim	Holes ¹	Holes ²	Part Code
CF16 / 35	1.33"	2.75"	127.0	16.0	6	6	CF3516TRAR
CF16 / 63	1.33"	4.50"	127.0	16.0	6	8	CF6316TRAR
CF16 / 100	1.33"	6.00"	127.0	16.0	6	16	CF10016TRAR
CF16 / 150	1.33"	8.00"	127.0	16.0	6	20	CF15016TRAR
CF16 / 200	1.33"	10.00"	127.0	16.0	6	24	CF20016TRAR
CF16 / 250	1.33"	12.00"	127.0	16.0	6	32	CF25016TRAR
CF35 / 63	2.75"	4.50"	127.0	34.8	6	8	CF6335TRAR
CF35 / 100	2.75"	6.00"	127.0	34.8	6	16	CF10035TRAR
CF35 / 150	2.75"	8.00"	127.0	34.8	6	20	CF15035TRAR
CF35 / 200	2.75"	10.00"	127.0	34.8	6	24	CF20035TRAR
CF35 / 250	2.75"	12.00"	127.0	34.8	6	32	CF25035TRAR
CF63 / 100	4.50"	6.00"	127.0	60.0	8	16	CF10063TRAR
CF63 / 150	4.50"	8.00"	127.0	60.0	8	20	CF15063TRAR
CF63 / 200	4.50"	10.00"	127.0	60.0	8	24	CF20063TRAR
CF63 / 250	4.50"	12.00"	127.0	60.0	8	32	CF25063TRAR
CF100 / 150	6.00"	8.00"	127.0	97.0	16	20	CF150100TRAR
CF100 / 200	6.00"	10.00"	127.0	97.0	16	24	CF200100TRAR
CF100 / 250	6.00"	12.00"	127.0	97.0	16	32	CF250100TRAR
CF150 / 200	8.00"	10.00"	127.0	148.0	20	24	CF200150TRAR
CF150 / 250	8.00"	12.00"	127.0	148.0	20	32	CF250150TRAR
CF200 / 250	10.00"	12.00"	127.0	197.0	24	32	CF250200TRAR

all dimensions are measured in millimetres (mm) unless otherwise stated

OFHC Copper Gaskets

SIZE	Material	Pack	Part Code
CF16	OFHC	10	CF16GCU
CF35	OFHC	10	CF35GCU
CF63	OFHC	10	CF63GCU
CF100	OFHC	10	CF100GCU
CF150	OFHC	10	CF150GCU
CF200	OFHC	10	CF200GCU
CF250	OFHC	1	CF250GCU

other gasket materials incl. annealed and plated also available

Hex Head Bolt Sets

SIZE	Material	Pack	Part Code
CF16	SS	25	HEX16BOLT
CF35	SS	25	HEX35BOLT
CF63	SS	25	HEX63BOLT
CF100	SS	25	HEX100BOLT
CF150	SS	25	HEX150BOLT
CF200	SS	25	HEX200BOLT
CF250	SS	32	HEX250BOLT

sets comprise bolts, washers and nuts
cap screw bolts, vented and plate-nut sets available

CF Reducers | Conical | Clearance Holes | SS 304L

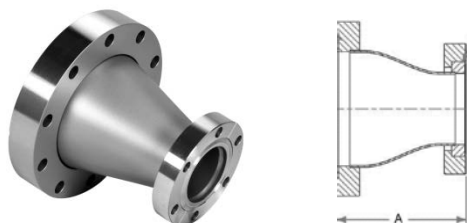

- Standard material: SS 304L
- Also available in SS 316LN and Aluminium
- Larger flange fixed/Smaller flange rotatable. Fixed flanges by request
- Other flange size combinations fabricated by request
- Use hex head bolt sets for clearance hole flanges
- Pressure range 1×10^{-9} mbar
- Temperature range: -195 to 300°C
- Full range of gaskets and bolt sets available in stock

SIZE	Smaller ¹ OD	Larger ² OD	A dim*	Bore	Holes ¹	Holes ²	Part Code
CF16 / 35	1.33"	2.75"	78.0	16.0	6	6	CF3516CRAR
CF35 / 63	2.75"	4.50"	75.0	34.8	6	8	CF6335CRAR
CF35 / 100	2.75"	6.00"	112.0	34.8	6	16	CF10035CRAR
CF35 / 150	2.75"	8.00"	130.0	34.8	6	20	CF15035CRAR
CF63 / 100	4.50"	6.00"	112.0	60.0	8	16	CF10063CRAR
CF63 / 150	4.50"	8.00"	130.0	60.0	8	20	CF15063CRAR
CF63 / 200	4.50"	10.00"	150.0	60.0	8	24	CF20063CRAR
CF100 / 150	6.00"	8.00"	130.0	97.0	16	20	CF150100CRAR
CF100 / 200	6.00"	10.00"	150.0	97.0	16	24	CF200100CRAR
CF150 / 200	8.00"	10.00"	150.0	148.0	20	24	CF200150CRAR

all dimensions are measured in millimetres (mm) unless otherwise stated
 *TBC subject to tube specification held in stock

OFHC Copper Gaskets

SIZE	Material	Pack	Part Code
CF16	OFHC	10	CF16GCU
CF35	OFHC	10	CF35GCU
CF63	OFHC	10	CF63GCU
CF100	OFHC	10	CF100GCU
CF150	OFHC	10	CF150GCU
CF200	OFHC	10	CF200GCU

other gasket materials incl. annealed and plated also available

Hex Head Bolt Sets

SIZE	Material	Pack	Part Code
CF16	SS	25	HEX16BOLT
CF35	SS	25	HEX35BOLT
CF63	SS	25	HEX63BOLT
CF100	SS	25	HEX100BOLT
CF150	SS	25	HEX150BOLT
CF200	SS	25	HEX200BOLT

sets comprise bolts, washers and nuts
 cap screw bolts, vented and plate-nut sets available



Contact us...



k-tech supplies ltd
wild thyme
udimore road
broadland row
broad oak
rye
east sussex
tn31 6bx
united kingdom

web : www.ktechsupplies.co.uk
email : enquiries@ktechsupplies.co.uk
tel : +44 (0)1424 400 235
fax : +44 (0)7006 044 223