



# HV & UHV Vacuum Products Catalogue

- ▶ COMPONENTS
- ▶ CONSUMABLES
- ▶ VALVES
- ▶ PUMPS
- ▶ GAUGES
- ▶ MANIPULATION

- ▶ MASS FLOW
- ▶ FEEDTHROUGHS
- ▶ CHAMBERS
- ▶ ASSEMBLIES
- ▶ MATERIALS
- ▶ SYSTEMS

# ISO Flanges and Components

- Centering Rings



## ISO Centering Rings

Page

C24	Centering Rings. Standard. SS/Viton & Trapped
C25	Centering Rings. Standard. SS/Nitrile & Trapped
C26	Centering Rings. Standard. Al/Viton & Trapped
C27	Centering Rings. Standard. Al/Nitrile & Trapped
C28	Centering Rings. Mesh Screen. SS/Viton
C29	Centering Rings. Metal Seal. Al Annealed

### CONTENTS



ISO Centering Rings | Standard | SS/VITON

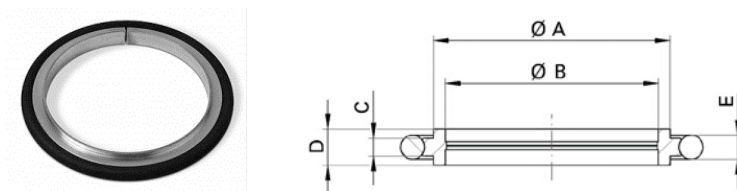

- Standard material: SS 304L...also available in Al
- Temperature range: VITON(Flurocarbon) -15 to 150°C
- Other O-ring materials available

NW	A dim	B dim	C dim	D dim	E dim	Part Code
ISO63	70.0	68.0	3.9	8.0	5.3	ISO63CRVSS
ISO80	83.0	81.0	3.9	8.0	5.3	ISO80CRVSS
ISO100	102.0	100.0	3.9	8.0	5.3	ISO100CRVSS
ISO160	153.0	151.0	3.9	8.0	5.3	ISO160CRVSS
ISO200	213.0	211.0	3.9	8.0	5.3	ISO200CRVSS
ISO250	261.0	259.0	3.9	8.0	5.3	ISO250CRVSS
ISO320	318.0	313.0	5.6	14.0	7.0	ISO320CRVSS
ISO400	-	-	-	-	-	See trapped section
ISO500	-	-	-	-	-	See trapped section
ISO630	-	-	-	-	-	See trapped section

all dimensions are measured in millimetres (mm) unless otherwise stated

ISO Centering Rings | Al Trapped | SS/VITON

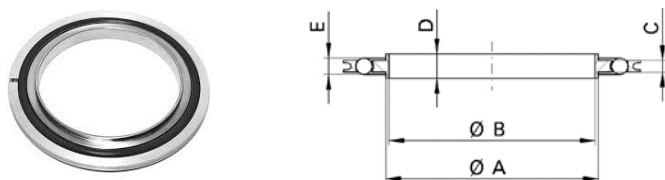

- Standard material: (Inner) SS 304L. (Outer Ring) Aluminium...also available as all Al
- Temperature range: VITON(Flurocarbon) -15 to 150°C
- Other O-ring materials available

NW	A dim	B dim	C dim	D dim	E dim	Part Code
ISO63	70.0	68.0	3.9	8.0	5.3	ISO63TCRVSS
ISO80	83.0	81.0	3.9	8.0	5.3	ISO80TCRVSS
ISO100	102.0	100.0	3.9	8.0	5.3	ISO100TCRVSS
ISO160	153.0	151.0	3.9	8.0	5.3	ISO160TCRVSS
ISO200	213.0	211.0	3.9	8.0	5.3	ISO200TCRVSS
ISO250	261.0	259.0	3.9	8.0	5.3	ISO250TCRVSS
ISO320	318.0	313.0	5.6	14.0	7.0	ISO320TCRVSS
ISO400	400.0	395.0	5.6	14.0	7.0	ISO400TCRVSS
ISO500	501.0	496.0	5.6	14.0	7.0	ISO500TCRVSS
ISO630	651.0	646.0	5.6	14.0	7.0	ISO630TCRVSS

all dimensions are measured in millimetres (mm) unless otherwise stated

ISO Centering Rings | Standard | SS/NITRILE

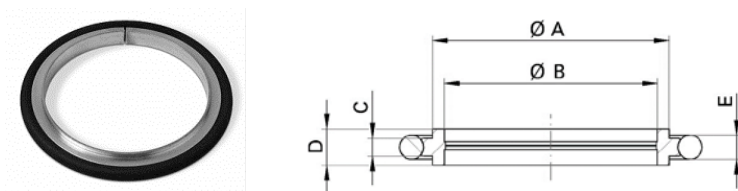

- Standard material: SS 304L...also available in Al
- Temperature range: NITRILE -20 to 120°C
- Other O-ring materials available

NW	A dim	B dim	C dim	D dim	E dim	Part Code
ISO63	70.0	68.0	3.9	8.0	5.3	ISO63CRNSS
ISO80	83.0	81.0	3.9	8.0	5.3	ISO80CRNSS
ISO100	102.0	100.0	3.9	8.0	5.3	ISO100CRNSS
ISO160	153.0	151.0	3.9	8.0	5.3	ISO160CRNSS
ISO200	213.0	211.0	3.9	8.0	5.3	ISO200CRNSS
ISO250	261.0	259.0	3.9	8.0	5.3	ISO250CRNSS
ISO320	318.0	313.0	5.6	14.0	7.0	ISO320CRNSS
ISO400	-	-	-	-	-	See trapped section
ISO500	-	-	-	-	-	See trapped section
ISO630	-	-	-	-	-	See trapped section

all dimensions are measured in millimetres (mm) unless otherwise stated

ISO Centering Rings | SS/NITRILE | AL TRAPPED

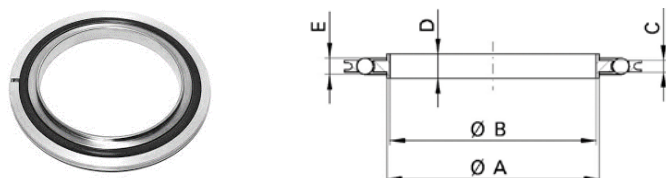

- Standard material: (Inner) SS 304L. (Outer Ring) Aluminium...also available as all Al
- Temperature range: NITRILE -20 to 120°C
- Other O-ring materials available

NW	A dim	B dim	C dim	D dim	E dim	Part Code
ISO63	70.0	68.0	3.9	8.0	5.3	ISO63TCRNSS
ISO80	83.0	81.0	3.9	8.0	5.3	ISO80TCRNSS
ISO100	102.0	100.0	3.9	8.0	5.3	ISO100TCRNSS
ISO160	153.0	151.0	3.9	8.0	5.3	ISO160TCRNSS
ISO200	213.0	211.0	3.9	8.0	5.3	ISO200TCRNSS
ISO250	261.0	259.0	3.9	8.0	5.3	ISO250TCRNSS
ISO320	318.0	313.0	5.6	14.0	7.0	ISO320TCRNSS
ISO400	400.0	395.0	5.6	14.0	7.0	ISO400TCRNSS
ISO500	501.0	496.0	5.6	14.0	7.0	ISO500TCRNSS
ISO630	651.0	646.0	5.6	14.0	7.0	ISO630TCRNSS

all dimensions are measured in millimetres (mm) unless otherwise stated

ISO Centering Rings | Standard | AL/VITON

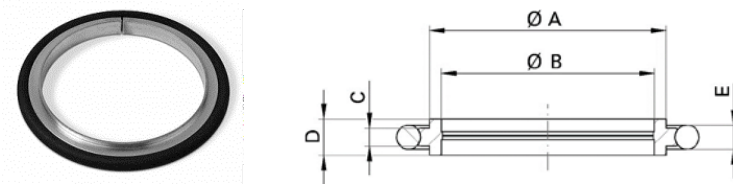

- Standard material: Aluminium(Al)...also available in SS 304L
- Temperature range: VITON(Fluorocarbon) -15 to 150°C
- Other O-ring materials available

NW	A dim	B dim	C dim	D dim	E dim	Part Code
ISO63	70.0	68.0	3.9	8.0	5.3	ISO63CRVAL
ISO80	83.0	81.0	3.9	8.0	5.3	ISO80CRVAL
ISO100	102.0	100.0	3.9	8.0	5.3	ISO100CRVAL
ISO160	153.0	151.0	3.9	8.0	5.3	ISO160CRVAL
ISO200	213.0	211.0	3.9	8.0	5.3	ISO200CRVAL
ISO250	261.0	259.0	3.9	8.0	5.3	ISO250CRVAL
ISO320	318.0	313.0	5.6	14.0	7.0	ISO320CRVAL
ISO400	-	-	-	-	-	See trapped section
ISO500	-	-	-	-	-	See trapped section
ISO630	-	-	-	-	-	See trapped section

all dimensions are measured in millimetres (mm) unless otherwise stated

ISO Centering Rings | AL/VITON | AL TRAPPED

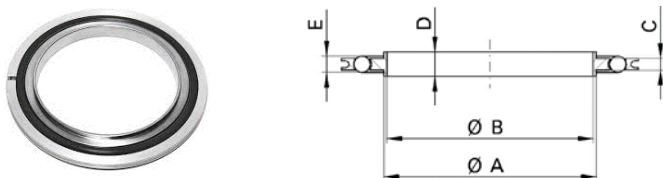

- Standard material: (Inner) Aluminium. (Outer Ring) Aluminium
- Temperature range: VITON(Fluorocarbon) -15 to 150°C
- Other O-ring materials available

NW	A dim	B dim	C dim	D dim	E dim	Part Code
ISO63	70.0	68.0	3.9	8.0	5.3	ISO63TCRVAL
ISO80	83.0	81.0	3.9	8.0	5.3	ISO80TCRVAL
ISO100	102.0	100.0	3.9	8.0	5.3	ISO100TCRVAL
ISO160	153.0	151.0	3.9	8.0	5.3	ISO160TCRVAL
ISO200	213.0	211.0	3.9	8.0	5.3	ISO200TCRVAL
ISO250	261.0	259.0	3.9	8.0	5.3	ISO250TCRVAL
ISO320	318.0	313.0	5.6	14.0	7.0	ISO320TCRVAL
ISO400	400.0	395.0	5.6	14.0	7.0	ISO400TCRVAL
ISO500	501.0	496.0	5.6	14.0	7.0	ISO500TCRVAL
ISO630	651.0	646.0	5.6	14.0	7.0	ISO630TCRVAL

all dimensions are measured in millimetres (mm) unless otherwise stated

ISO Centering Rings | Standard | AL/NITRILE

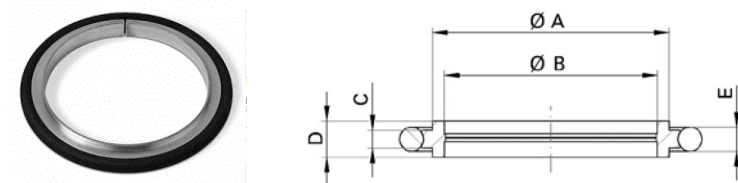

- Standard material: Aluminium(Al)...also available in SS 304L
- Temperature range: NITRILE -20 to 120°C
- Other O-ring materials available

NW	A dim	B dim	C dim	D dim	E dim	Part Code
ISO63	70.0	68.0	3.9	8.0	5.3	ISO63CRNAL
ISO80	83.0	81.0	3.9	8.0	5.3	ISO80CRNAL
ISO100	102.0	100.0	3.9	8.0	5.3	ISO100CRNAL
ISO160	153.0	151.0	3.9	8.0	5.3	ISO160CRNAL
ISO200	213.0	211.0	3.9	8.0	5.3	ISO200CRNAL
ISO250	261.0	259.0	3.9	8.0	5.3	ISO250CRNAL
ISO320	318.0	313.0	5.6	14.0	7.0	ISO320CRNAL
ISO400	-	-	-	-	-	See trapped section
ISO500	-	-	-	-	-	See trapped section
ISO630	-	-	-	-	-	See trapped section

all dimensions are measured in millimetres (mm) unless otherwise stated

ISO Centering Rings | AL/NITRILE | AL TRAPPED

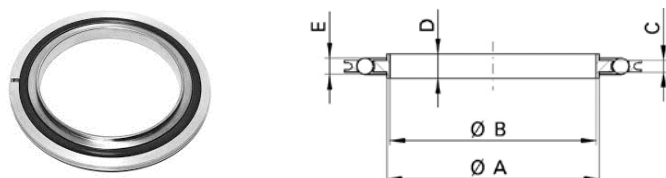

- Standard material: (Inner) Aluminium. (Outer Ring) Aluminium
- Temperature range: NITRILE -20 to 120°C
- Other O-ring materials available

NW	A dim	B dim	C dim	D dim	E dim	Part Code
ISO63	70.0	68.0	3.9	8.0	5.3	ISO63TCRNAL
ISO80	83.0	81.0	3.9	8.0	5.3	ISO80TCRNAL
ISO100	102.0	100.0	3.9	8.0	5.3	ISO100TCRNAL
ISO160	153.0	151.0	3.9	8.0	5.3	ISO160TCRNAL
ISO200	213.0	211.0	3.9	8.0	5.3	ISO200TCRNAL
ISO250	261.0	259.0	3.9	8.0	5.3	ISO250TCRNAL
ISO320	318.0	313.0	5.6	14.0	7.0	ISO320TCRNAL
ISO400	400.0	395.0	5.6	14.0	7.0	ISO400TCRNAL
ISO500	501.0	496.0	5.6	14.0	7.0	ISO500TCRNAL
ISO630	651.0	646.0	5.6	14.0	7.0	ISO630TCRNAL

all dimensions are measured in millimetres (mm) unless otherwise stated

## ISO Centering Rings | Mesh Screen | SS/VITON

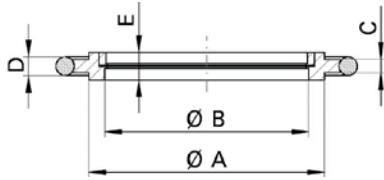

- Inner ring and mesh materials: SS 304L
- O-ring materials: VITON(Fluorocarbon)
- Wire thickness approx.: 0.3mm
- Mesh size approx.: 0.5mm
- Other wire/mesh sizes available by request
- Temperature range: VITON -15 to 150°C
- Other O-ring materials available

NW	A dim	B dim	C dim	D dim	E dim	Part Code
ISO63	70.0	60.0	3.9	5.3	8.0	ISO63CRVSS-M
ISO80	83.0	73.0	3.9	5.3	8.0	ISO80CRVSS-M
ISO100	102.0	92.0	3.9	5.3	8.0	ISO100CRVSS-M
ISO160	153.0	43.0	3.9	5.3	8.0	ISO160CRVSS-M
ISO200	213.0	200.0	3.9	5.3	8.0	ISO200CRVSS-M
ISO250	261.0	247.0	3.9	5.3	8.0	ISO250CRVSS-M

all dimensions are measured in millimetres (mm) unless otherwise stated

ISO Centering Rings | Metal Seal | Al

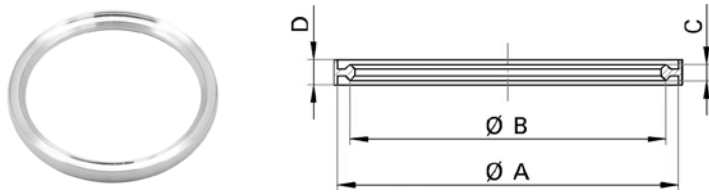

- Ring materials: Aluminium 6082 Annealed
- No gas permeation
- For use with SS flanges
- Temperature range: -195 to 150°C

NW	A dim	B dim	C dim	D dim	Part Code
ISO63	95.0	88.0	4.5	7.0	ISO63CRAL
ISO80	110.0	103.0	4.5	7.0	ISO80CRAL
ISO100	130.0	123.0	4.5	7.0	ISO100CRAL
ISO160	180.0	173.0	4.5	7.0	ISO160CRAL
ISO200	240.0	233.0	4.5	7.0	ISO200CRAL
ISO250	290.0	283.0	4.5	7.0	ISO250CRAL

all dimensions are measured in millimetres (mm) unless otherwise stated





Contact us...



k-tech supplies ltd  
wild thyme  
udimore road  
broadland row  
broad oak  
rye  
east sussex  
tn31 6bx  
united kingdom

web : [www.ktechsupplies.co.uk](http://www.ktechsupplies.co.uk)  
email : [enquiries@ktechsupplies.co.uk](mailto:enquiries@ktechsupplies.co.uk)  
tel : +44 (0)1424 400 235  
fax : +44 (0)7006 044 223